

# LC300 & LC420

## PARTS BREAKDOWN

LC300 & LC420 PARTS BREAKDOWN

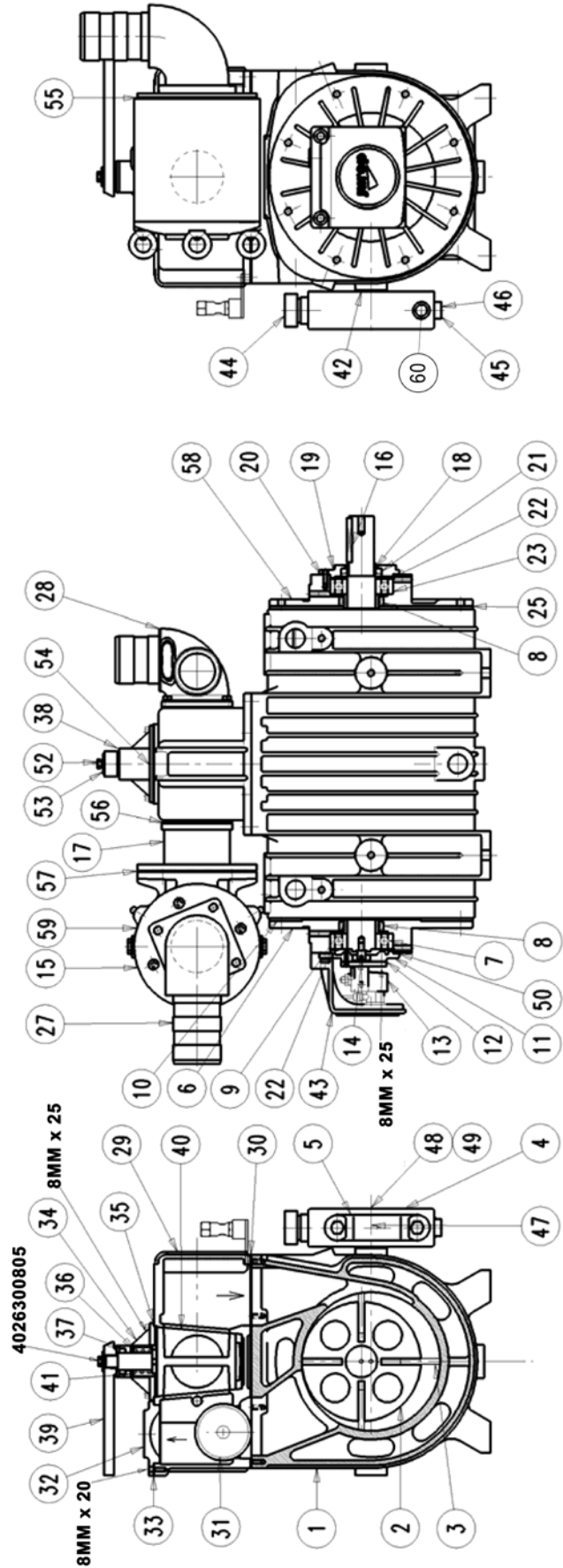

POS.	PART#	DESCRIPTION	QTY.
1	1687508200	Pump housing LC420	1
	16875BHDB0	Pump housing LC 300	1
2	1521505700	Pump rotor dir LC 420	1
	1521506400	Pump rotor dir LC 300	1
3	1601606300	Vane LC 420	4
	1601606400	Vane LC 300	4
4	1587009400	Oil tank	1
5	4022106001	Oil tank dip stick (oil tank sight eye)	1
6	1610513500	Flange	1
7	4023100046	Bearing 6309 C3	1
8	4022200113	Pump rotor seal ring	2
9	1624037600	Seal ring bushing 45/60/22	2
10	1680709800	Gasket	2
11	1610512900	Oil pump flange	1
12	1680609700	Oil pump gasket	1
13	4024251000	Oil pump cw rotation	1
14	1622002600	Oil pump pivot	1
15	1445002900	Filter	1
16	4026501008	Key 12 x 8 x 70	1
17	1627104400	Final Filter Mounting Flange LC 420	1
	1627104500	Final Filter Mounting Flange LC 300	1
18	1626001100	Seal ring bushing 40/45/20	1
19	1610508200	Direct drive small flange	1
20	1680707300	Front small flange gasket	1
21	4022200044	Seal ring 65/45/8	1
22	4026300025	Compensation ring	2
23	4023100046-LC	Bearing Drive End	1
24	4022200113	Seal ring	1
25	1680709800	Flange gasket	1
26	1642600100	Drive shaft protection	1
27	1852103800	Orient. air conveyors Kit Ø76 (3")	1
28	1852104800	Fix air conveyors Kit Ø76 (3")LC420	1
	1852103800	Fix air conveyors Kit Ø76 (3")LC300	1
29	1627506100	Manifold LC420	1
	1627505300	Manifold LC300	1
30	1680614300	Manifold gasket LC 420	1
	1680611400	Discharge Manifold gasket LC 300	1
	1680611500	Suction Manifold gasket LC 300	1
31	4023250502	Rubber ball Ø90 LC 420	1
	4023250501	Rubber ball Ø80 LC 300	1
32	1610509800	Manifold small flange LC 420	1
	1610510800	Manifold small flange LC 420	1
33	1680610500	Manifold small flange gasket LC420	1
	1680611600	Manifold small flange gasket LC300	1
34	1623100500	Cock manifold LC420	1
	1623100000	Cock manifold LC300	1
35	1680707800	Manifold gasket LC420	1
	1680700200	Manifold gasket LC300	1
36	1691000000	Cock spring	1
37	4022200030	Cock spring 41x27x10	1
38	1624202300	Cock regulating spacer	1
39	1605500100	Cock lever	1
40	1608502500	Cock LC420	1
	1608503100	Cock LC300	1
41	1624027500	Cock spring spacer LC420	1
	1624027500	Cock spring spacer LC300	1
42	1685600200	Rubber washer	2
43	1642100200	Oil pump protection	1
44	4026910103	Oil tank fplug	1
45	4026904503	Oil tank plug	1
46	1685100300	Alu-washer	2
47	4026171211	Screw M12x80	2
48	4026305508	Selflocking nut M12	2
49	4026357007	Washer M12	2
50	1680707300	Oil pump flange gasket	1
51	4026300025	Compensation ring	2
52	4026135414	Screw M8x45	1
53	1685002800	Washer 30 x 8.5 x 4	1
54	1681006800	Vacuum-pressure plate	1
55	1680609200	Gasket	1
56	1680709900	Gasket	1
57	1680609100	Gasket	1
58	1610513500	Flange	1
59	1610051600	Flange	1
60	4022106001	Oil Sight Glass	1
-	189207X2B0	Kit gasket	1

[www.chandlerequipment.com](http://www.chandlerequipment.com)

Due to unforeseeable market fluctuations, prices are subject to change without notice.



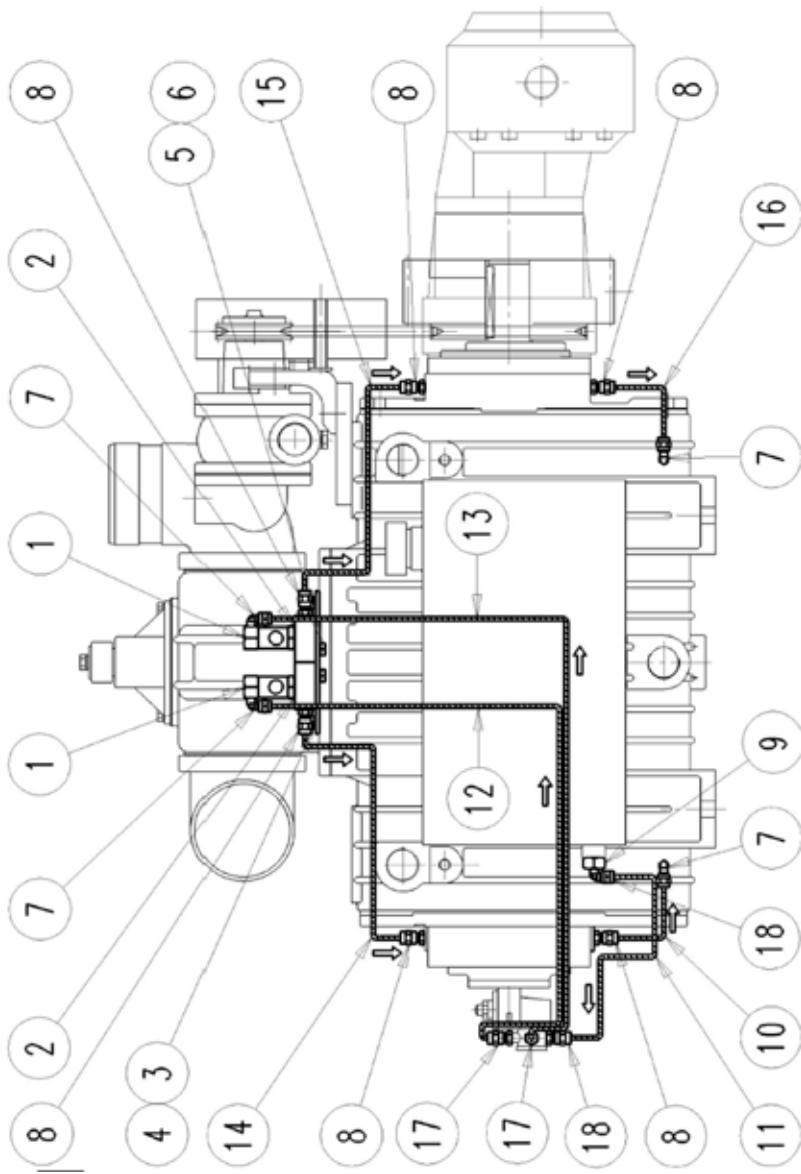

POS.	PART#	DESCRIPTION	QTY.
1	I401200700	Oil dripper automatic lubrication 2	2
2	I685100000	Alu washer 2	2
3	4026350909	Washer M8 6798 2	2
4	4026107111	Screw UNI 5739 M8 x 30 8.8 2	2
5	4026102704	Screw UNI 5739 M6 x 16 8.8 2	2
6	4026350908	Washer M6 6798 2	2
7	4026706000	Fitting 90 1/8"-Ø4 5	5
8	4026702000	Fitting 1/8"-Ø4 9	9
9	I673001000	Oil fitting	1
	4022300001	Oil suction filter 1 l	1
10	I66301TOB0	Housing-rear flange oil line Dir- HDR-USA sx	1
	I66301SZB0	Housing-rear flange oil line Dir- HDR-USA dx l	1
11	I66301SWB0	Suction oil tank oil line Dir dx LC420 l	1
	I6630D5MB0	Suction oil tank oil line Dir dx LC300 l	1
	I66301SXB0	Suction oil tank oil line Dir sx LC420 l	1
	I6630D5PBO	Suction oil tank oil line Dir sx LC300 l	1
	I66301SVB0	Suction oil tank oil line HDR dx LC420 l	1
	I6630D5LBO	Suction oil tank oil line HDR dx LC300 l	1
	I66301SUB0	Suction oil tank oil line HDR sx LC 420 l	1
	I6630D5JBO	Suction oil tank oil line HDR sx LC 300 l	1
	I66303QWB0	Suction oil tank oil line USA LC 420 l	1
		Suction oil tank oil line USA LC 300 l	1
12	I663062600	Short discharge oil line Dir-USA dx LC420 l	1
	I6630D5WB0	Short discharge oil line Dir-USA dx LC300 l	1
	I66301TSB0	Short discharge oil line Dir-USA sx LC420 l	1
	I6630D5XB0	Short discharge oil line Dir-USA sx LC300 l	1
	I66301T4B0	Long discharge oil line HDR dx LC420 l	1
	I6630D5VB0	Long discharge oil line HDR dx LC300 l	1
	I66301T2B0	Long discharge oil line HDR sx LC420 l	1
	I6630D5UB0	Long discharge oil line HDR sx LC300 l	1
13	I663062700	Long discharge oil line Dir-USA dx LC420 l	1
	I6630D50B0	Long discharge oil line Dir-USA dx LC300 l	1
	I66301T8B0	Long discharge oil line Dir-USA sx LC420 l	1
	I6630561B0	Long discharge oil line Dir-USA sx LC300 l	1
	I66301T7B0	Long discharge oil line HDR dx LC420 l	1
	I6630D5ZB0	Long discharge oil line HDR dx LC300 l	1
	I66301T6B0	Long discharge oil line HDR sx LC420 l	1
	I6630D5YB0	Long discharge oil line HDR sx LC300 l	1
14	I66301T1B0	Rear flange oil line Dir-HDR-USA dx LC420 l	1
	I6630D5TB0	Rear flange oil line Dir-HDR-USA dx LC300 l	1
	I66301STB0	Rear flange oil line Dir-HDR-USA sx LC420 l	1
	I6630D5SB0	Rear flange oil line Dir-HDR-USA sx LC300 l	1
15	I66301STB0	Front flange oil line Dir-HDR-USA dx LC420 l	1
	I6630D5SB0	Front flange oil line Dir-HDR-USA dx LC300 l	1
	I66301T1B0	Front flange oil line Dir-HDR-USA sx LC420 l	1
	I6630D5TB0	Front flange oil line Dir-HDR-USA sx LC300 l	1
16	I66301TOB0	Housing-front flange oil line Dir - HDR-USA dx	1
	I66301SZB0	Housing-front flange oil line Dir-HDR-USA sx l	1
17	4026706101	Orientable pressure fitting G1/8"Ø4 2	2
18	4026706003	Elbow fitting G1/8"-Ø6 2	2
19	4032401003	6mm Oil Line	
20	4026702004	Straight Brass Oil Line Fitting	
21	4026706004	90° Elbow Brass Oil Line Fitting	